

25 Years of Manufacturing Excellence

**zeta**<sup>®</sup>  
ALARM SYSTEMS



# Simplicity Plus Hard & Soft Addressable Fire Alarm System

# Simplicity Plus

## Addressable Fire Alarm System

### Simplicity

#### Noun

- the quality or condition of being easy to understand or do
- the quality or condition of being uncomplicated in form or design
- (count noun) a thing that is uncomplicated

#### Phrases

- be simplicity itself
- be extremely easy: **programming this system is simplicity itself**

The Simplicity Plus is the ideal introduction to the world of addressable fire alarm panels.

As its name suggests, it has been designed with ease of use in mind, using pre-programmed values for its programming options. The installer simply needs to configure the loop and enter text labels via the built in keypad (optional).

The Simplicity Plus has user definable zones, option for zonal or common alarm operation, options for I/O operation, alarm verification and user selectable languages.

It can be connected to an RS232 desktop printer for real time event log printing (Epson LQ300+ recommended) and it can also drive a serial repeater model AD-REP/M (Part No. 37-157).



### Nuisance Alarms Filter - Alarm Verification

To help prevent false alarm causing a full evacuation, any smoke detector can be set to alarm verification mode with a time delay of between 30 seconds and 3 minutes 45 seconds. Should any of these detectors go into alarm then only the detector's LEDs and sound/flasher base (if connected) will activate. Should the alarm not be cleared with this time delay then a common alarm will occur.

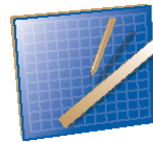

### Standards

The Simplicity Plus fire alarm control panel has been designed to meet the full requirements of EN54 part 2 and EN54 part 4.

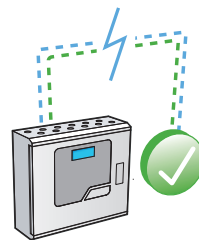

### Cable Break Protection

In the event of a cable break, the panel will report the break. The devices after the break will be lost, but will be listed one-by-one on the panel display to help locate the break.



### Installation & Commissioning

In addition to the benefits already listed, once the panel has been connected a 'Device Count Verification' feature will confirm the number and type of every device. This can then be checked against the system specification.



### System Monitoring

Since every device is monitored constantly and communicates with the panel at a maximum interval of 4 seconds, any malfunction in any device will be reported by the panel. This of course will include the exact location of the device.



## Features

- ✓ One or Two loop addressable fire alarm panel (64, 126 or 252 device capacity)
- ✓ Certified to EN54 parts 2 & 4
- ✓ User definable zones
- ✓ Option for zonal or common alarm operation
- ✓ Options for I/O operation
- ✓ Alarm verification (help prevent false alarms)
- ✓ User selectable languages
- ✓ Set of changeover relay contacts for fault condition
- ✓ Set of changeover relay contacts for fire condition
- ✓ 2,048 event log (fire & fault)
- ✓ Zone or device disablement
- ✓ One man test mode
- ✓ Plug & play, no need for any special tools or laptop for commissioning
- ✓ Fully integrated keypad
- ✓ All associated devices are loop powered

## Zeta Alarm Watch

Using the Zeta alarm watch software, multiple panels can be monitored from a central PC. The panels can be grouped by company to give a structured display on the PC.



## Soft Addressing

The MKII Handheld Programmer (MKII-TOOL) is designed to compliment all MKII devices and to assist the commissioning engineer on site.



Smoke and heat detectors can be tested when plugged on the programmer and alarm LED's can be verified prior to installation.

The unit will softly address all devices without using the incorporated dip-switch on the field devices.

The MKII Programmer can re-program the opto-heat detectors to either heat or smoke detector.

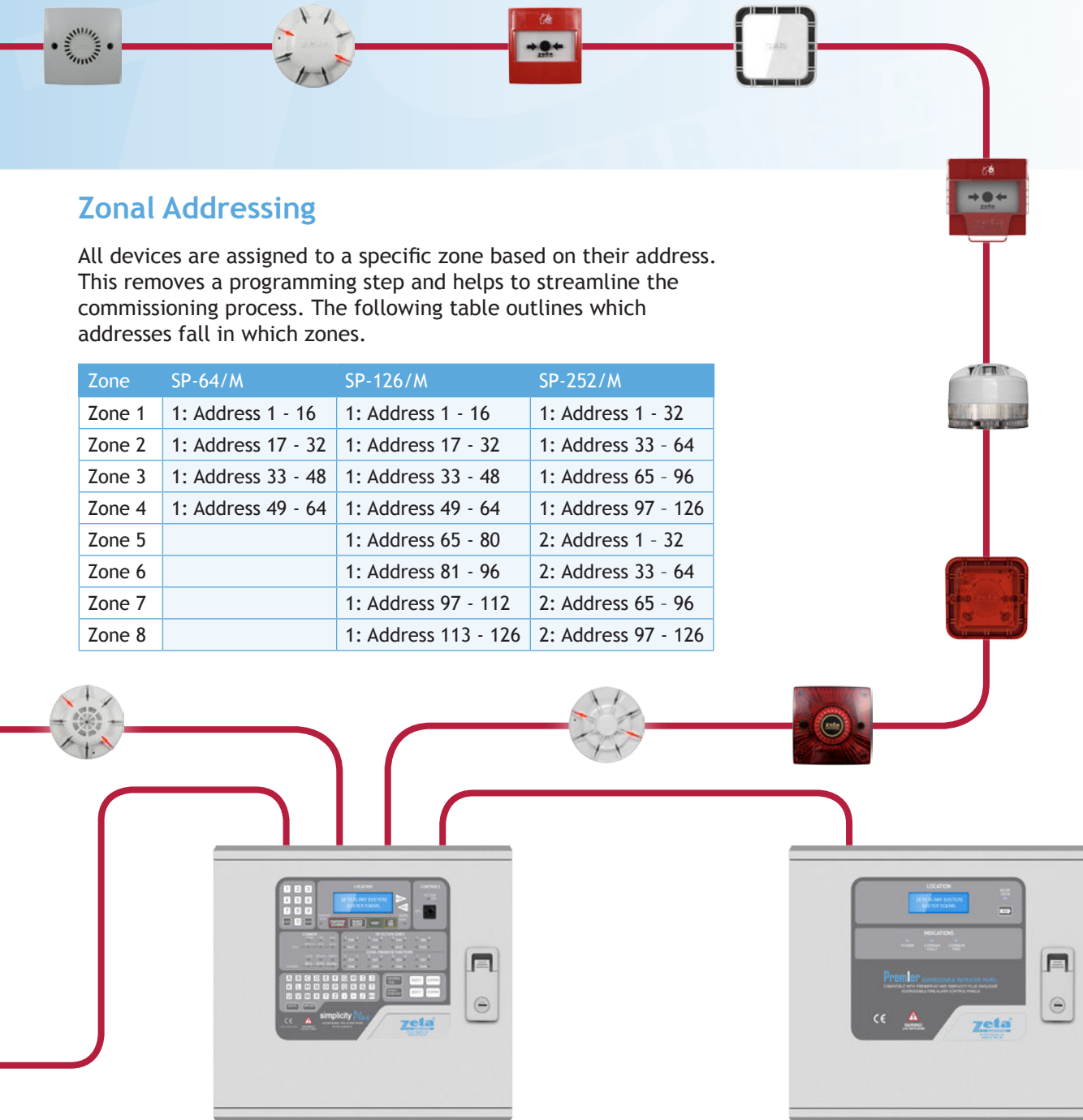

## Zonal Addressing

All devices are assigned to a specific zone based on their address. This removes a programming step and helps to streamline the commissioning process. The following table outlines which addresses fall in which zones.

Zone	SP-64/M	SP-126/M	SP-252/M
Zone 1	1: Address 1 - 16	1: Address 1 - 16	1: Address 1 - 32
Zone 2	1: Address 17 - 32	1: Address 17 - 32	1: Address 33 - 64
Zone 3	1: Address 33 - 48	1: Address 33 - 48	1: Address 65 - 96
Zone 4	1: Address 49 - 64	1: Address 49 - 64	1: Address 97 - 126
Zone 5		1: Address 65 - 80	2: Address 1 - 32
Zone 6		1: Address 81 - 96	2: Address 33 - 64
Zone 7		1: Address 97 - 112	2: Address 65 - 96
Zone 8		1: Address 113 - 126	2: Address 97 - 126

### The Simplicity panel can transmit the following information

- ✓ Device alarm (including loop & address information)
- ✓ Device fault (including loop & address information)
- ✓ Panel reset
- ✓ Loop reconfigured
- ✓ Loop wiring fault
- ✓ Power supply fault
- ✓ Earth fault
- ✓ Clock reset
- ✓ Evacuation started

### Features

- ✓ Addressable repeater panel (display only, no controls)
- ✓ Complies fully to EN54 parts 2 & 4

Model	AD-REP/M
Part No.	37-157
Supply Voltage	20 - 30 V DC
System Voltage	29V DC (Nominal)
Connections	Supply + , Supply - , Data + , Data -
Operating Temperature	-0°C to 50°C
Enclosure Size (mm)	(W) 375 x (H) 335 x (D) 75mm
Weight	1 KG

# Simplicity Plus

## Addressble Fire Alarm System

### Device Order Codes

Fyreye MKII Addressable Detectors (DIFT Approved)		
MKII-AOP	80-210	Fyreye MKII Addressable Optical Smoke Detector
MKII-AHR	80-212	Fyreye MKII Addressable Rate of Rise Heat Detector
MKII-AHF	80-214	Fyreye MKII Addressable Fixed Heat Detector
MKII-AOH	80-216	Fyreye MKII Addressable Combined Smoke & Heat Detector
Fyreye MKII Addressable Detector Bases		
MKII-CB	80-220	Fyreye MKII Common Base
MKII-CB/D	80-221	Fyreye MKII Deep Base
MKII-IB	80-0908	Fyreye MKII Isolator Base
MKII-ISO	80-0918	Fyreye MKII Stand-Alone Isolator
Fyreye MKII Handheld Programming Tool		
MKII-TOOL	48-004	Fyreye MKII Handheld Programming Tool-
Fyreye MKII Sandwich Sounder/Flasher		
MKII-SSB	80-224	MKII Sandwich Sounder (no address required)
MKII-SSFB	80-225	MKII Sandwich Sounder/Flasher (no address required)
Zeta Addressable Manual Call Points		
ZT-CP3/AD	43-621	Zeta Addressable Surface Mount Manual Call Point
CP3-FMB	43-635	Zeta CP3 Call Point Flush Mount Bezel
CP3-CV	43-636	Zeta CP3 Call Point Cover
CP3-KEY	43-637	Zeta CP3 Call Reset Key
ZT-CP3/AD/WP	43-622	Zeta Addressable Weatherproof Manual Call Point (Surface Mount Only)
Zeta Xtratone Addressable Sounder, Flasher & Combined Sounder Flasher (MKII)		
MKII-AXT/R	42-610	Zeta Addressable Xtratone Sounder, Red, Fyreye II Protocol
MKII-AXT/W	42-611	Zeta Addressable Xtratone Sounder, White, Fyreye II Protocol
MKII-AXTSF/R	42-612	Zeta Addressable Xtratone Sounder Flasher, Red, Fyreye II Protocol
MKII-AXTF/R	42-613	Zeta Addressable Xtratone Flasher, Red, Fyreye II Protocol
Zeta Miditone Addressable Sounders and Combined Sounder & Flasher (MKII)		
MKII-AMD/8R	42-600	Zeta Miditone Addressable Sounder (Red)
MKII-AMD/8W	42-601	Zeta Miditone Addressable Sounder (White)
MKII-AMSF/R	42-602	Zeta Miditone Addressable Combined Sounder & Flasher (Red)
MKII-AMF/R	42-603	Zeta Miditone Addressable Flasher Only (Red)
Zeta Maxitone Addressable Sounders and Combined Sounder & Flasher		
MKII-AMT/R	42-620	Zeta Maxitone Addressable Sounder (Red)
MKII-AMT/W	42-621	Zeta Maxitone Addressable Sounder (White)
MKII-AMTSF/R	42-622	Zeta Maxitone Addressable Combined Sounder & Flasher (Red)
MKII-AMTF/R	42-623	Zeta Maxitone Addressable Flasher Only
Fyreye MKII Addressable Interfaces		
ZAI-MI	48-101	Fyreye MKII Addressable Input Module with S/C Isolator (loop powered)
ZAIO-MI	48-108	Fyreye MKII Addressable Input/Output Module with S/C Isolator (loop powered)
ZASC-MI	48-112	Fyreye MKII Addressable Sounder Circuit Controller with S/C Isolator (need ext PSU)
ZAZM-MI	48-117	Fyreye MKII Addressable Zone Monitoring Unit with S/C Isolator (loop powered)



# Other Zeta Products

25 Years of Manufacturing Excellence



**INFINITY *iD2***  
The 2 Wire Fire Detection System for Professionals



25 Years of Manufacturing Excellence



**Premier M Plus & Infinity 8**  
Conventional Fire Alarm Systems



25 Years of Manufacturing Excellence



**Premier Quatro**  
Addressable Fire Alarm System



**Gas Sense**  
Gas Detection System



**Premier EVACS 16**  
Voice Alarm System



25 Years of Manufacturing Excellence



**eclipse**  
Security Alarm Systems

Available now from:

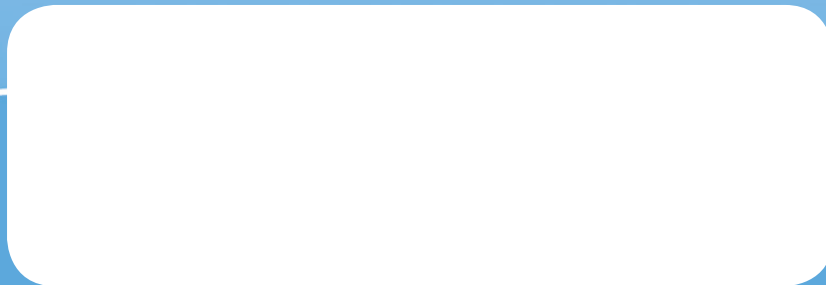

Assessed to ISO 9001: 2008  
Certificate number 330

**GLT Exports Ltd**  
MANUFACTURERS OF FIRE ALARM EQUIPMENT

Tel: +44 (0) 1792 455 175  
Fax: +44 (0) 1792 455 176

Email: [info@zetaalarmsystems.com](mailto:info@zetaalarmsystems.com)  
Web: [www.zetaalarmsystems.com](http://www.zetaalarmsystems.com)

Detection House  
72-78 Morfa Road  
Swansea  
SA1 2EN  
United Kingdom